



Acoustic Panel

Keep Your Secrets
to Yourself

Natural European Oak Veneer &
PVC/PP Options Available!

- A level sound insulator acoustic felt.
- B1 level fire retardant acoustic felt.
- Reduces background noises such as echo and howling.
- Oak veneer option matches perfectly with The Madera Series.
- Easy to cut and apply.

Dimensions (mm)	
Width	605
Length	2800
Thickness	22

*thickness options available

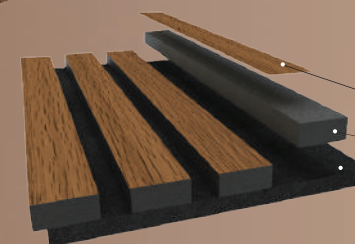
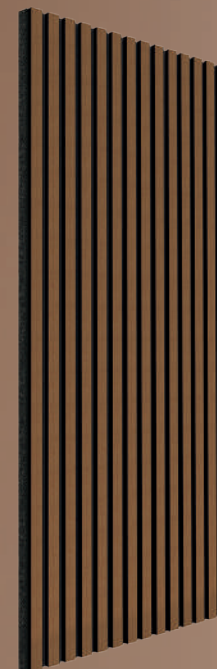

Colección de
madera
0,6 MM NATURAL EUROPEAN OAK
VENEER / PVC-PP OPTIONS
12 MM BLACK COLORED MDF
9 MM PET ACOUSTIC FELT



Decorate in 3 Easy Steps

Measure



Measure the Wall You Want to
Apply Acoustic Panels.

Cut



Cut the Acoustic Panel
According to Wall Dimensions.

Apply

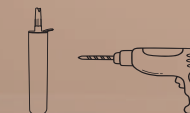

Apply Polyurethane (PU)
Assembly Glue to the Back of the
Acoustic Panel / Or Use a Nail Gun
to Mount it on the Wall.

OAK COLOR COLLECTION



MAP501

MAP502

MAP504

MAP505

PVC / PP COLOR COLLECTION



PAP303

PAP310

PAP312

PAP316



PAP317

PAP1070

*Other colors may be produced upon request.

ACOUSTIC FELT NRC TEST RESULT (Noise Reduction Coefficient Test)

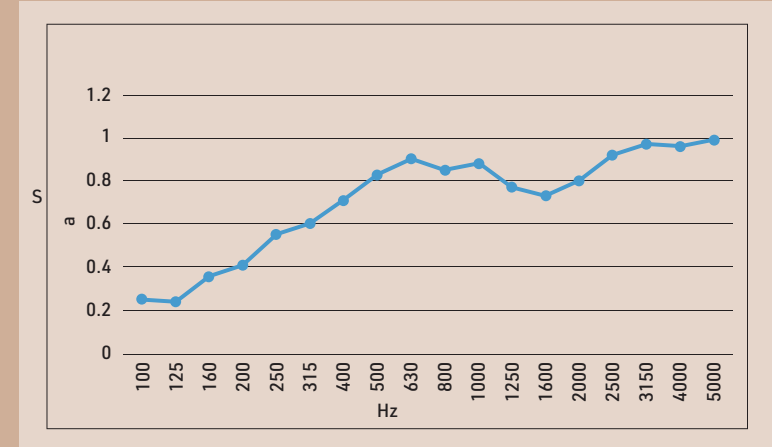

NRC (Noise Reduction Coefficient Test) 0.75

Flame Spread index 26-75 Class B

Smoke-Developed index 0-450 Class B

ACOUSTIC FELT FSI 30 RESULT - ASTM E84-2021 standard test method used to assess the surface burning characteristics of a material used for interior wall and ceiling finishes, with results measured by Flame Spread Index (FSI)

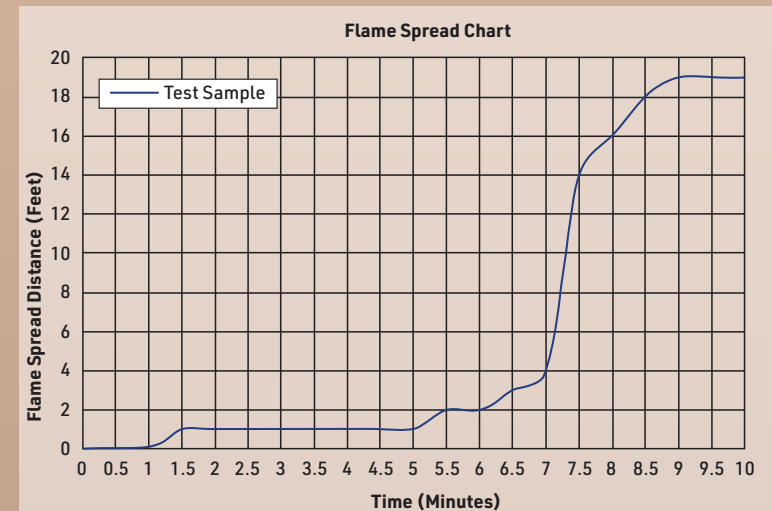



Acoustic Panel

Keep Your Secrets
to Yourself

Natural European Oak Veneer &
PVC/PP Options Available!

- A level sound insulator acoustic felt.
- B1 level fire retardant acoustic felt.
- Reduces background noises such as echo and howling.
- Oak veneer option matches perfectly with The Madera Series.
- Easy to cut and apply.

Dimensions (mm)	
Width	605
Length	2800
Thickness	22

*thickness options available

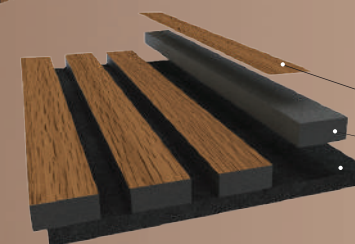

Colección de
madera
0,6 MM NATURAL EUROPEAN OAK
VENEER / PVC-PP OPTIONS
12 MM BLACK COLORED MDF
9 MM PET ACOUSTIC FELT



Decorate in 3 Easy Steps

Measure



Measure the Wall You Want to
Apply Acoustic Panels.

Cut



Cut the Acoustic Panel
According to Wall Dimensions.

Apply

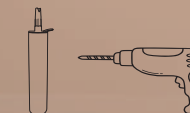

Apply Polyurethane (PU)
Assembly Glue to the Back of the
Acoustic Panel / Or Use a Nail Gun
to Mount it on the Wall.

OAK COLOR COLLECTION



MAP501

MAP502

MAP504

MAP505

PVC / PP COLOR COLLECTION



PAP303

PAP310

PAP312

PAP316



PAP317

PAP1070

*Other colors may be produced upon request.

ACOUSTIC FELT NRC TEST RESULT (Noise Reduction Coefficient Test)

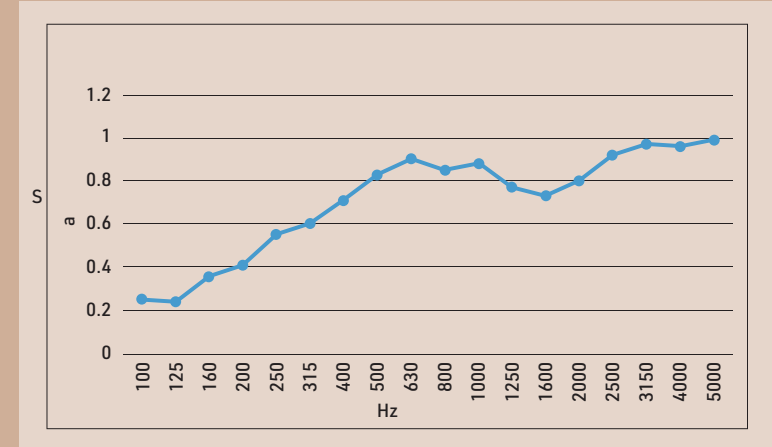

NRC (Noise Reduction Coefficient Test) 0.75

Flame Spread index 26-75 Class B

Smoke-Developed index 0-450 Class B

ACOUSTIC FELT FSI 30 RESULT - ASTM E84-2021 standard test method used to assess the surface burning characteristics of a material used for interior wall and ceiling finishes, with results measured by Flame Spread Index (FSI)

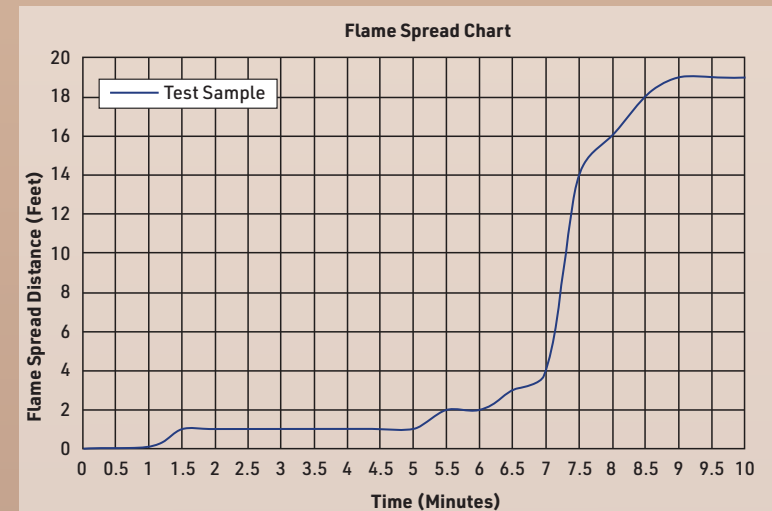



TECHNOMATT

NEW GENERATION

ANTI-FINGERPRINT ACRYLIC PANEL

Technomatt

Smooth surface,Pleasant feeling...



Advanced anti-fingerprint technology
Excellent scratch resistance
Outstanding stain resistance
Increased UV resistance



Tecnomatt acrylic surface

Innovative antibacterial coating



Outstanding stain resistance

Waterproof polyurethane adhesive that matches the front colour



Smudge resistant

Abrasion resistant and resistant to group 1B chemicals



Anti-fingerprint Surface



Conventional surfaces



Tecnomatt surface

*Our product dimensions are 1220x2800x18mm





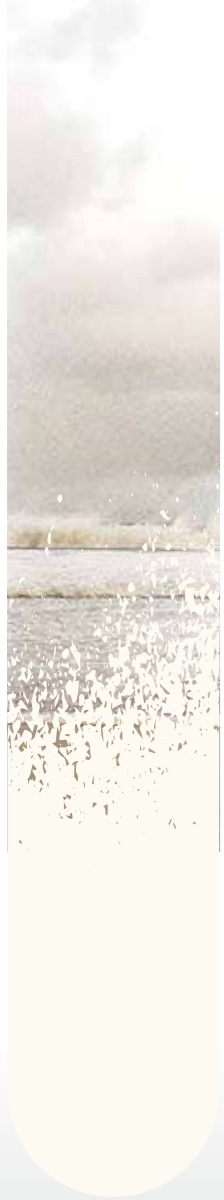

AF10



AF22



AF36



AF35



AF34

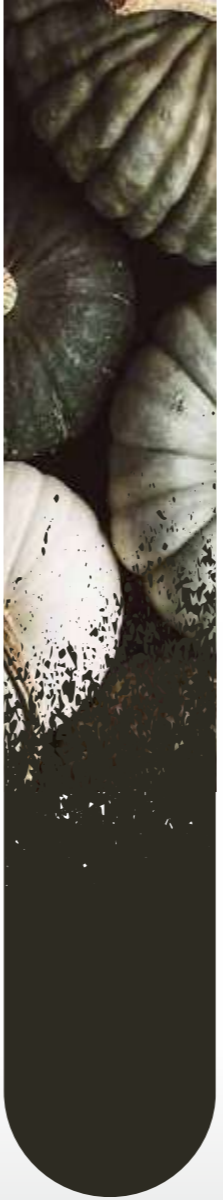

AF37



AF40



AF51



AF50



AF60



Antibacterial surface
properties according to
ISO 22196 / JIS Z 2801



TECHNICAL DATA SHEET

No	FEATURE	RESULT	STANDARD
1	Gloss level (60° angle)	< 5 GLE	DIN 67530
2	Scratch resistance (rating group 4 B)	> 2 N	DIN 68861/T4
3	Assessment of surface resistance to wet heat (70°C)	No change (8B)	DIN 68861/T8
4	Assessment of surface resistance to dry heat (75°C)	No change (7D)	DIN 68861/T7
5	Colour Fastness (Delta E) (Colour difference after 200 h Xenon test)	DE <1,7	ISO 4892-2
6	Haze	<10	DIN 67530
7	Chemical resistance	No visible changes	DIN 68861/T1
8	Behaviour to water vapour	No changes visible	AMK
9	Thickness tolerance	± 0,3 mm	Gizir
10	Bow tolerance	3,5 mm / m	Gizir
11	Density	≥ 1.07 ≤ 1.12 g/cm ³	ISO 1183-1
12	Resistance to steel wool	class 1. no changes or scratches visible	TEST METHOD QPA-25-LT

*) These values are weighted average of the test results.



gizir.com

info@gizir.com

İSTANBUL

Export Office & Showroom

Barbaros Mah. Begonya Sok.
Nidakule Ataşehir Kuzey Sit.
No: 3/70 Ataşehir / İstanbul

T: +90 (216) 519 33 73

ADANA

Headquarters

Organize Sanayi Bölgesi,
Çanakkale Cad. No: 17
01250 Sarıçam / Adana

T: +90 (322) 394 43 40 (pbx)



Laminates
& Things



3D
PANEL

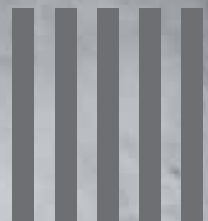
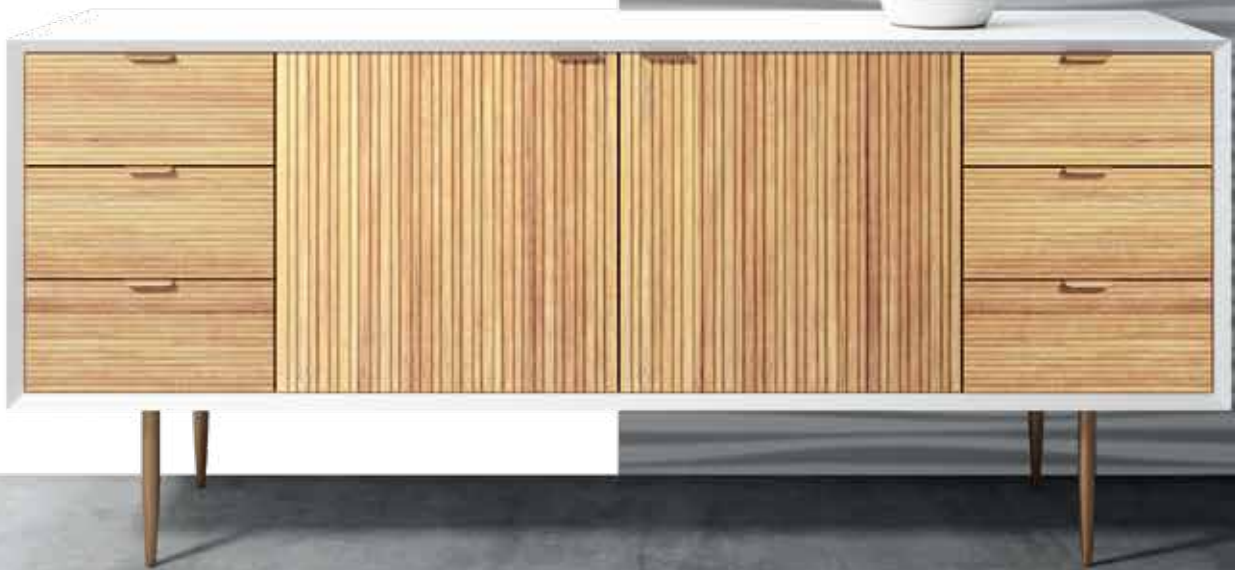



What is 3D PANEL?

3D Panel is our newest innovative solution for premium interior furniture. MDF is first laminated with a foam layer. Then, foam laminated MDF is covered with the desired foil. As the last step, pressure is applied on the panel to give it the desired 3D design.

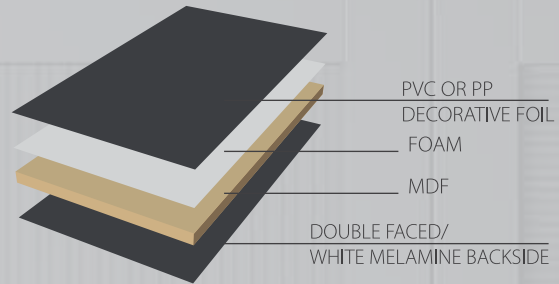

**DOUBLE FACED/
WHITE MELAMINE
BACKSIDE**

PANEL DIMENSIONS

Width	1220mm
Length	2800mm
Thickness	18/10mm

*thickness options available

COLOR & DECORS

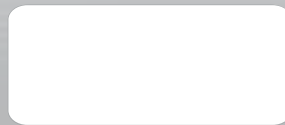

S010 | S.M. White



S027 | S.M. Mink

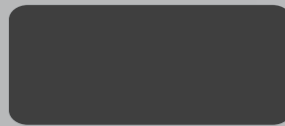

S036 | S.M. Dark Grey



S038 | S.M. Dust Grey

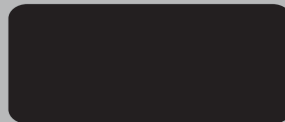

S040 | S.M. Black



4040 | Silver



A360 | P. Teak

6 Design Options

available in MATT & SUPERMATT



3D01

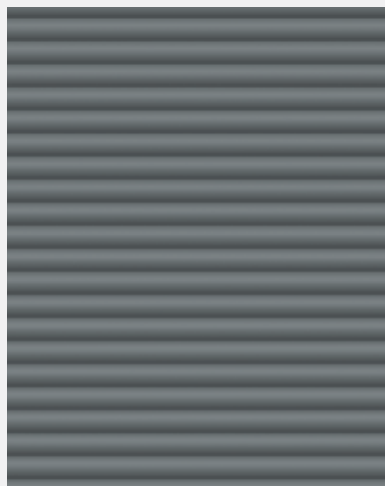

3D02

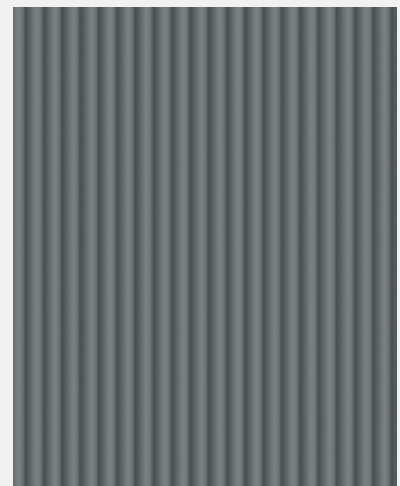

3D03



3D04

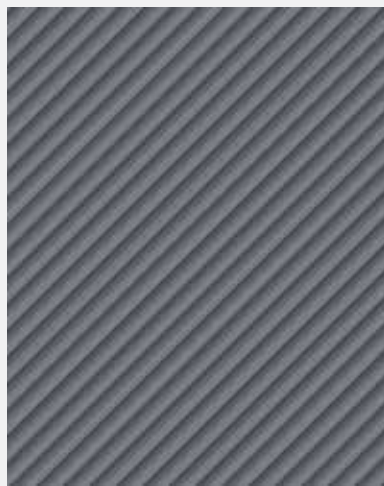
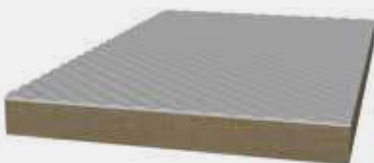

3D05

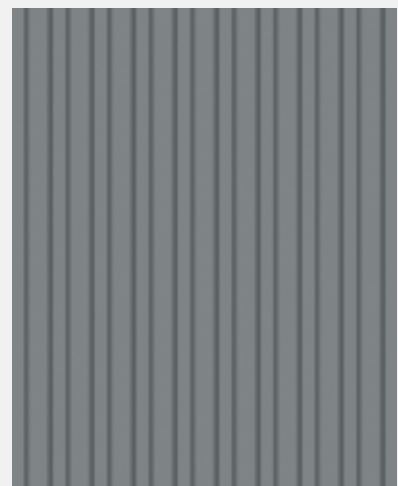
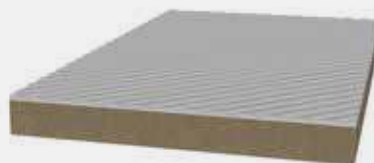

3D06



*Custom designs can be made upon request.

How to FINISH THE SIDES?

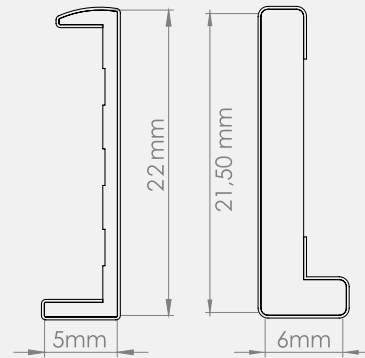
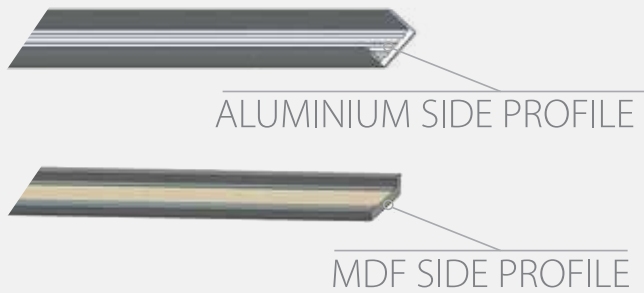

SIDE PROFILES (mm)	
Length	2800
Width	22 / 21,5

Instead of regular edgebanding, aluminium or MDF edge profiles of same color & foil are used to achieve a cleaner & more elegant look. Accessories can be applied by using PU transparent mounting adhesive in the applications of aluminium edge profiles.

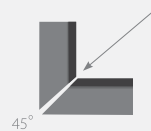
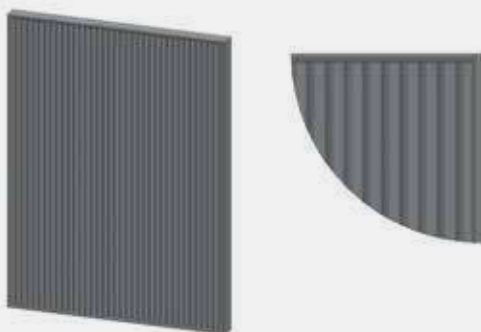
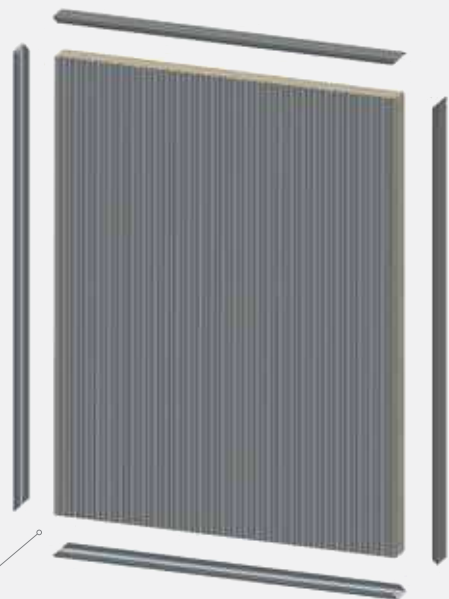

If aluminium edge profiles are going to be used for all 4 sides, they should be cut in a 45° angle.

*Custom designs can be made upon request.

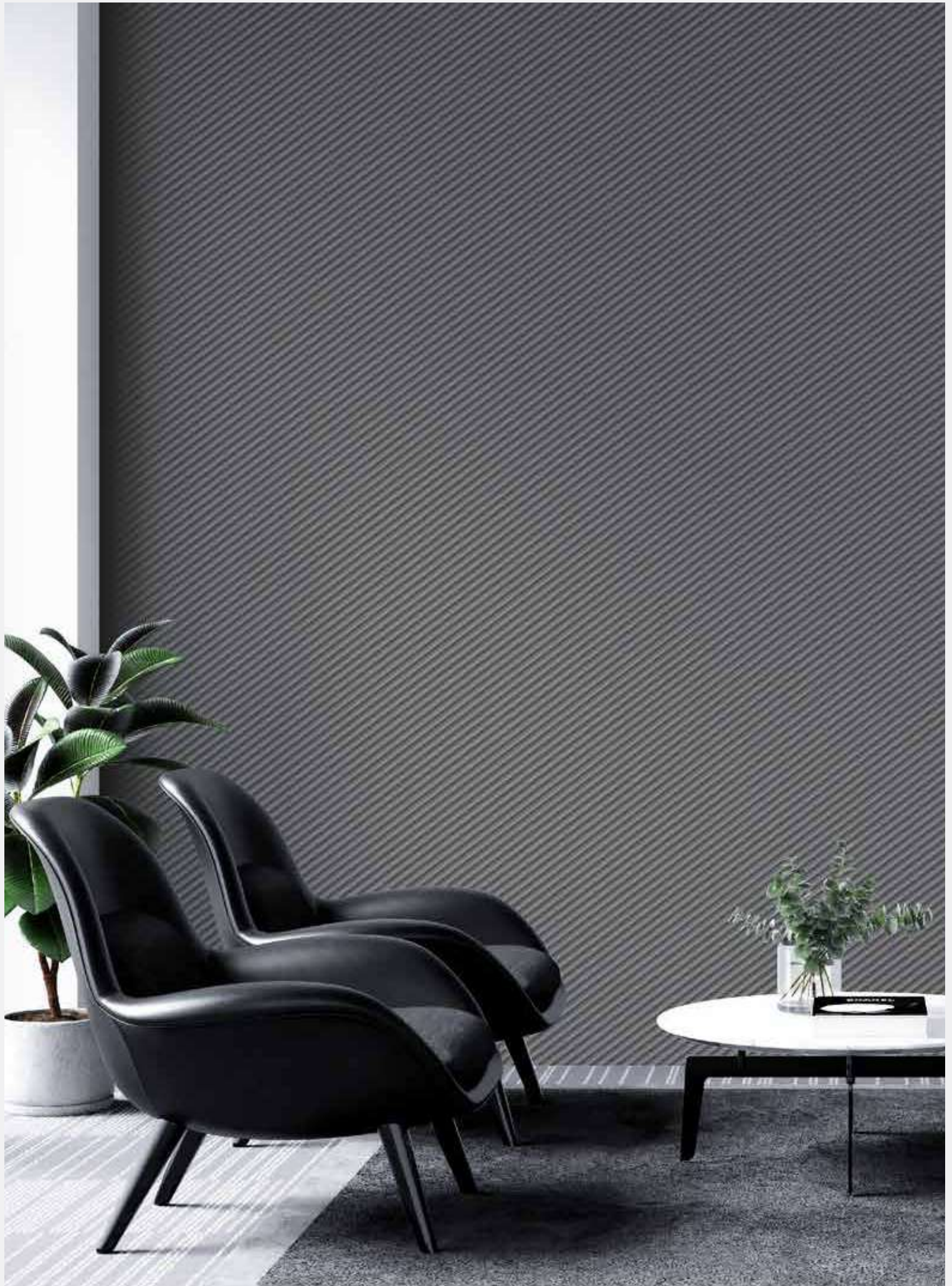



TECHNICAL INFORMATIONS

No	FEATURE	VALUE	RESULT (Super matt)	STANDART
1	Gloss level (60° angle)	-	5 GU	TS EN 14323
2	Scratch resistance	H	3H	TS 7385
3	Assessment of surface resistance to wet heat (85°C)	5	5 (No change)	TS EN 12721+A1:2014:02
4	Assessment of surface resistance to dry heat (70°C)	5	5 (No change)	TS EN 12722+A1:2014:02
5	Surface abrasion resistance	5	250 rev. (Class 4)	TS EN 14323 : 2021-12 6.9
6	Behavior towards impact loading by falling steel ball	5	2 (There is change)	TS EN 14323:2021-12 6.13
7	Test of water steam resistance	5	2 (There is change)	TS EN 14323:2021-21,Art. 6.10
8	Resistance to staining	5	5 (No change)	TS EN 14323 6.6
9	Assessment of surface resistance to chemical cold liquids (Acetic acid, acetone, ammonia solution, citric acid, cleaning agent, etc.)	5	5 (No change)	TS EN 12720:2009+A1:2014-02
10	Colorfastness to light	5	5. Grade	TS EN 15187
11	Thickness tolerance	-	± 0,30 mm	TS EN 324-1
12	Bow tolerance	-	3,5 mm / m	Gizir
13	Width and Length tolerance	-	± 5 mm / m	TS EN 324-1

- These values are weighted average of the test results.

- The test results of the 6th and 7th tests became the 2nd level out of the 5th level according to the product standard determined by TSE.



HEADQUARTERS

1596 West 34th Place
Hialeah, Florida 33012

Contact us: +1 (305) 362-8080
www.laminatesandthings.com





Laminates
& Things



Colección de
madera

NATURAL EUROPEAN

 ***OAK VENEER***



gizir
WOOD PRODUCTS

NATURAL EUROPEAN OAK VENEER

Colección de
madera



- 0,6 mm Natural European Oak Veneer.
- Already Vernished, Just Apply Edgeband and Use.
- 7 Color Options.
- High Scratch Resistance.
- Resistance to heat.
- Supermatt & Haptic feeling.
- Antibacterial Surface.
- High UV Resistance.
- Double Faced - Matching Natural Oak Veneer Edgeband / ABS Edgeband.
- Raw Option Available.



COLOR COLLECTION



VM000



VM504



VM505

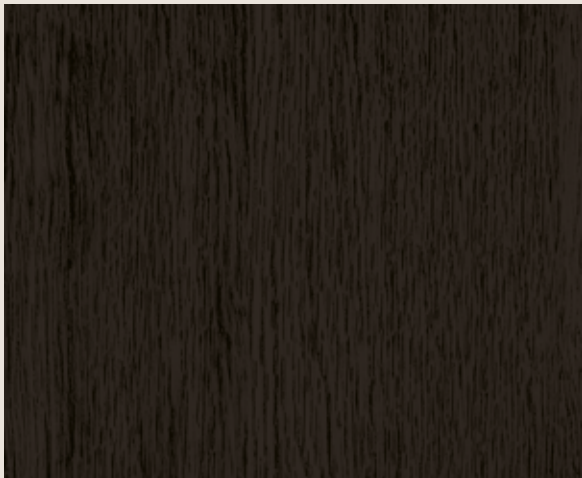

VM506

Dimensions (mm)	
Width	1220
Length	2800
Thickness	19/09

*thickness options available

Edgeband Thickness (mm)	
Oak	0,5
ABS	0,8



**DOUBLE FACED /
MATCHING
BACKSIDE**

**HIGH
QUALITY**



sample for VM501



*Colors may vary, ask for samples.

sample for VM502

Colección de
madera



*Colors may vary, ask for samples.

sample for VM503



sample for VM504



*Colors may vary, ask for samples.

sample for VM505

Colección de
madera



*Colors may vary, ask for samples.

sample for VM506

NATURAL EUROPEAN OAK VENEER

TECHNICAL INFORMATIONS

Colección de
madera

No	FEATURE	UNIT	VM 500 series	STANDARD
1	Gloss level (60° angle)	Gloss	3,0 GU	TS EN 14323: 2021-+C2:C1612, Art. 6,12
2	Scratch resistance	N	1,2 N (class 4D)	DIN 68861-4: 2013-02
3	Cross-cut test (paints and varnishes)	Class	1a-1 (Classification 1)	TS EN ISO 2409: 2013-06
4	Surface resistance to micro-scratches (Method B)	Class	5th grade 5 (no change)	TS EN 16611:2023
5	Thickness of the top layer	mm	0,480 mm	TS EN 13647
6	Assessment of surface resistance to chemical cold liquids (Acetic acid, acetone, ammonia solution, citric acid, cleaning agent, ethanol etc.)	Class	5th grade 5 (no change)	TS EN 12720: 2009+ A1: 2015-01
7	Bending strength	N / mm!	In the transverse direction= 24.9 N/mm2 In the longitudinal direction= 34.1 N/mm2 Average= 29.5 N/mm2	TS EN 310: 2009-04
8	Modulus of elasticity in bending	N / mm!	Transverse direction= 2841 N/mm2 In the longitudinal direction = 3719 N/mm2 Average= 3280 N/mm2	TS EN 310: 2009-04
9	Surface soundness (tensile strength)	N / mm!	1,39 N/mm2	TS EN 311: 2005-03
10	Tensile strength vertical to the surface	N / mm!	0,45 N/mm2	TS EN 319: 1999-04
11	Density	kg / m³	728 kg/m3	EN 323 TS EN 323:1999-04
12	Determination of swelling in thickness after immersion in water (24 hours)	-	1,10%	TS EN 317: 1999-04
13	Thickness tolerance	mm	± 0,3 mm	TS EN 324-1
14	Bow tolerance	mm / m	3,2 mm / m	Gizir
15	Anti Bacterial Activity Analysis	-	91,2% No problem	ISO 22196:2011
16	Safety of Toys - Part 3: Migration of Certain Elements	-	Suitable	TS EN 71-3+A3:2018-11
17	Assessment of surface resistance to wet heat (80 C)	Class	Rating 5 (no change)	TS EN 12721+A1: 2014-02
18	Assessment of surface resistance to dry heat (100 C)	Class	Rating 5 (no change)	TS EN 12722+A1: 2014-02
19	Resistance to impact by large-diameter steel ball (500 mm 1500 mm)	mm	No cracks were observed at a drop height of 1400 mm	TS EN 14323: 2021-12, Art. 6,13
20	Resistance to staining	Class	Benchmark 5	TS EN 14323: 2021-12, Art. 6,6
21	Burning cigarette	Class	Benchmark 3	EN 438-2+A1: 2018
22	Colorfastness to light	Grey Scala	4/5 Grade (according to grey scale)	EN 15187
23	Colorfastness to light (400 hour)	Grey Scala	4 Grade (according to grey scale)	TS EN 15187: 2009-03

(*) These values are weighted average of the test results.



**Laminates
& Things**

HEADQUARTERS

1596 West 34th Place
Hialeah, Florida 33012

Contact us: +1 (305) 362-8080
www.laminatesandthings.com

